



# 12GHz Surface Mount Bandpass Filter

**B120MB1S**



DLI • Novacap • Syfer • Voltronics

www.dilabs.com

www.knowlescapacitors.com

## DESCRIPTION

DLI's 12GHz bandpass filter offers unmatched size and performance in a surface mount configuration. This filter utilizes DLI's low loss temperature stable materials which offer small size and minimal performance variation over temperature.

## FEATURES

- Small Size
- Frequency Stable over Temperature
- Solder Surface Mount Package
- Excellent Repeatability
- Operating Temp: -55°C to +125°C
- Characteristic Impedance: 50Ω

## SPECIFICATIONS\*

Parameter	Frequency Range	Min	Typ.	Max
Insertion Loss (dB)	11.5 - 12.5		2	3
Return Loss (dB)		14	18	
Low Side Rejection (dB)	DC -10.65	30	40	
High Side Rejection (dB)	13.15 - 20	30	40	
Input Power (W)				TBD

\*Electrical specifications based on typical probed performance at room temperature. Insertion loss shall vary ±0.5dB over temperature.

## Typical Measured Performance

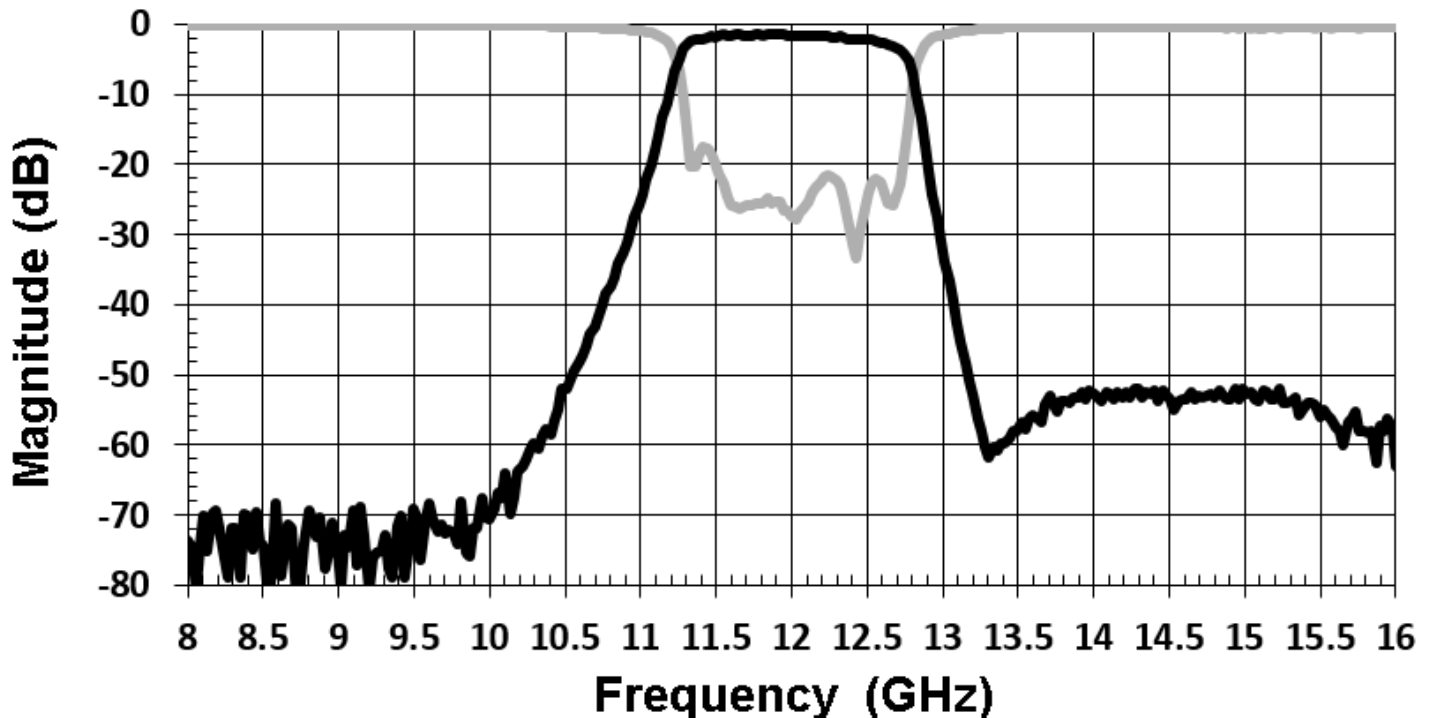



# 12GHz Surface Mount Bandpass Filter

**B120MB1S**



DLI • Novacap • Syfer • Voltronics

www.dilabs.com

www.knowlesc capacitors.com

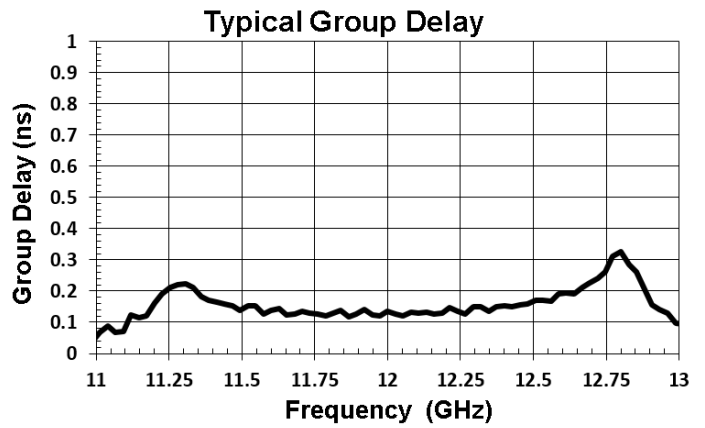
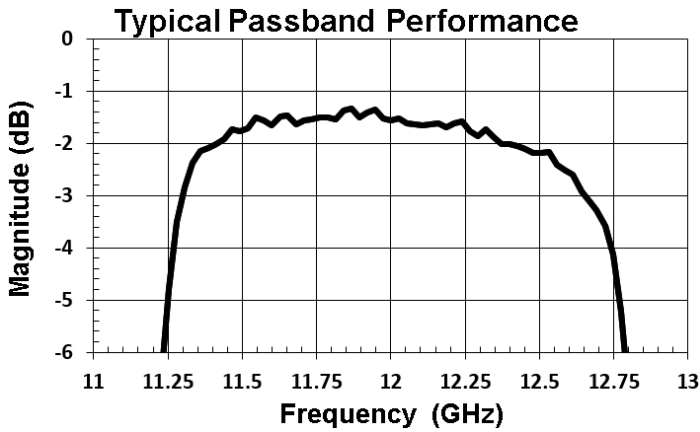

## Physical Dimensions

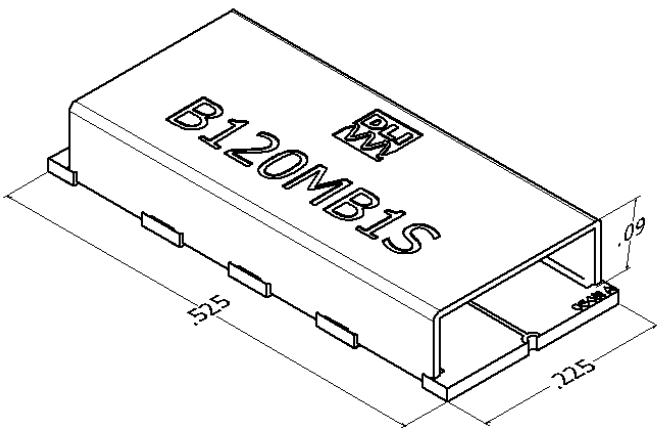

Isometric View

Units = inches

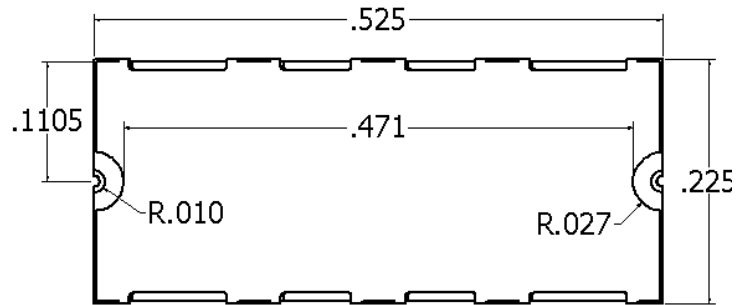

Bottom View

## Recommended PCB Layout

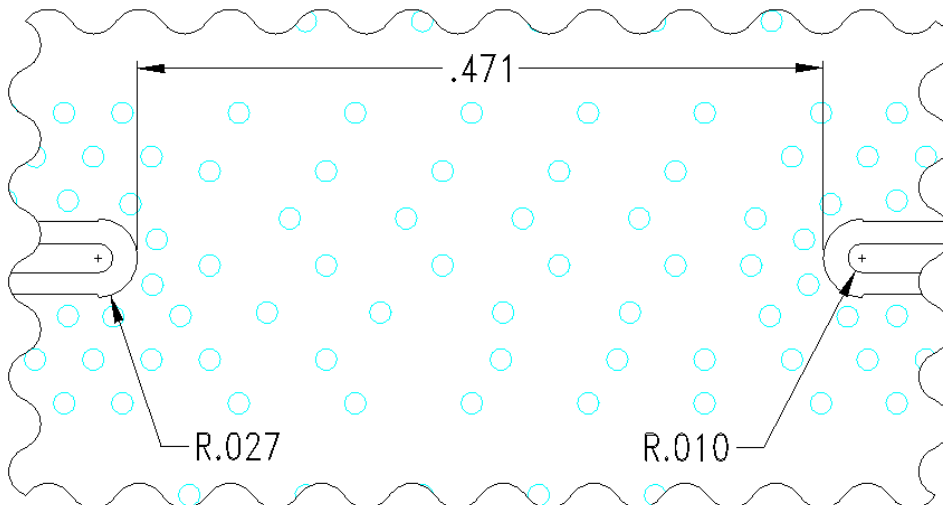

- 50Ω trace dimensions are application specific.
- Ensure adequate grounding beneath the part.

